

Detailed Analysis Results in the Port of Fukushima Daiichi NPS, around Discharge Channel and Bank Protection (Sampling Locations of Underground Water Obtained at Bank Protection)

● Sampling locations of underground water obtained at bank

East seawall break

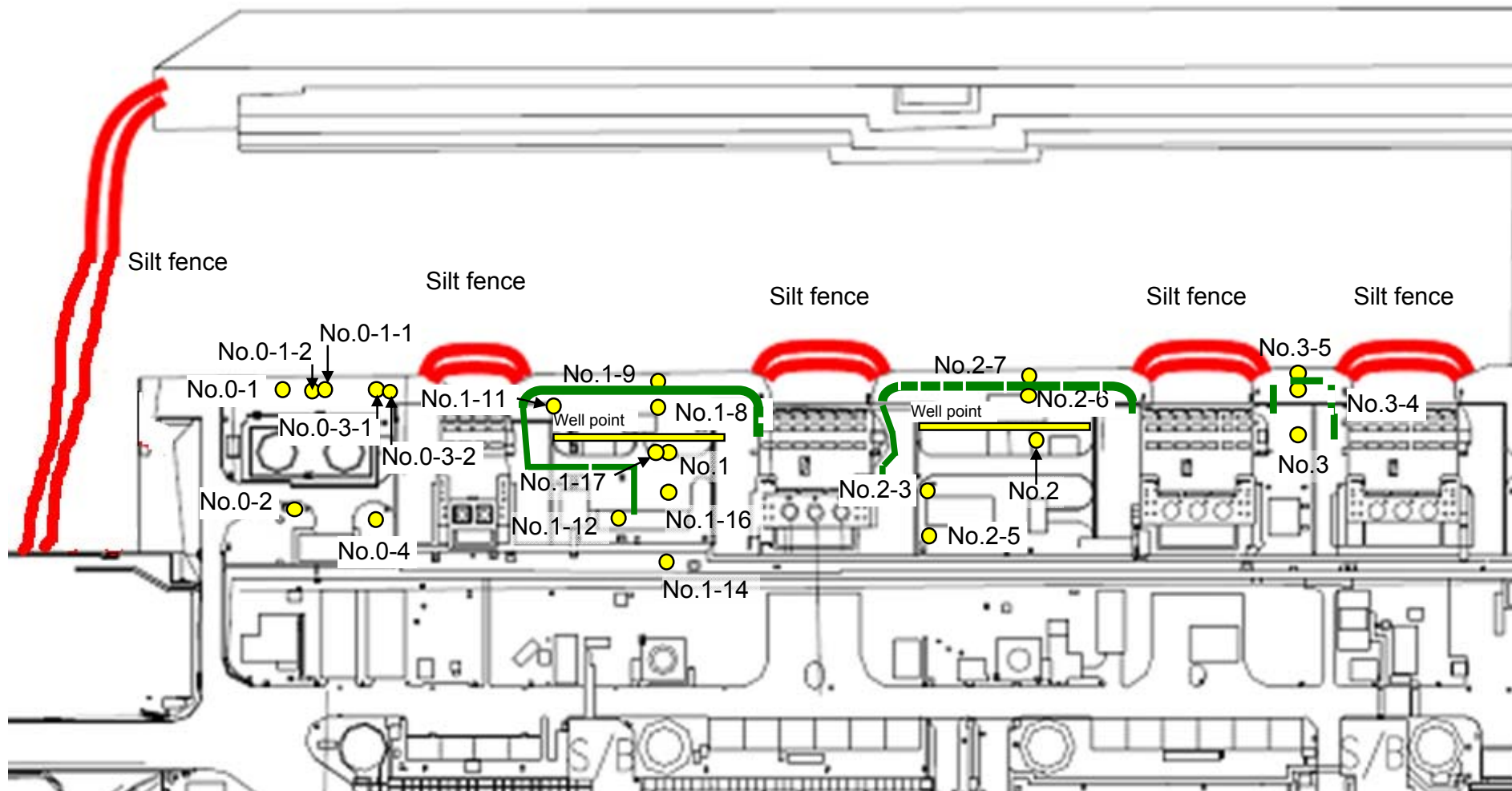

— : Location where ground improvement construction was completed, or being implemented (as of December 4)

Detailed Analysis Results in the Port of Fukushima Daiichi NPS, around Discharge Channel and Bank Protection (1/4) Underground Water Obtained at Bank Protection

Unit: Bq/L (exclude chloride)

| | Underground water observation hole No.0-1 | Underground water observation hole No.0-1-1 | Underground water observation hole No.0-1-2 | Underground water observation hole No.0-2 | Underground water observation hole No.0-3-1 | Underground water observation hole No.0-3-2 | Underground water observation hole No.0-4 | Underground water observation hole No.1 | Underground water observation hole No.1-8 | Underground water observation hole No.1-9 | Underground water observation hole No.1-11 | Underground water observation hole No.1-12 | Underground water observation hole No.1-14 |
|--------------------------|---|---|---|---|---|---|---|---|---|---|--|--|--|
| Date of sampling | / | / | / | / | / | / | / | Dec 19, 2013 | / | / | Dec 19, 2013 | Dec 19, 2013 | Dec 19, 2013 |
| Time of sampling | / | / | / | / | / | / | / | 9:59 AM | / | / | 9:18 AM | 10:39 AM | 11:00 AM |
| Chloride (unit: ppm) | / | / | / | / | / | / | / | - | / | / | - | - | - |
| Cs-134 (Approx. 2 years) | / | / | / | / | / | / | / | ND(0.41) | / | / | 0.90 | 5.5 | ND(0.52) |
| Cs-137 (Approx.30 years) | / | / | / | / | / | / | / | ND(0.51) | / | / | 1.7 | 13 | 1.3 |
| The other γ | / | / | / | / | / | / | / | | / | / | | | |
| Gross β | / | / | / | / | / | / | / | 480 | / | / | 28 | 74 | 240 |
| H-3 (Approx. 12 years) | / | / | / | / | / | / | / | 230,000 | / | / | 21,000 | 84,000 | 7,900 |
| Sr-90 (Approx. 29 years) | / | / | / | / | / | / | / | - | / | / | - | - | - |

| | Underground water observation hole No.1-16 | Underground water observation hole No.1-17 | Groundwater pumped up from the well point (between Unit 1 and 2) | Underground water observation hole No.2 | Underground water observation hole No.2-3 | Underground water observation hole No.2-5 | Underground water observation hole No.2-6 | Underground water observation hole No.2-7 | Groundwater pumped up from the well point (between Unit 2 and 3) | Underground water observation hole No.3 | Underground water observation hole No.3-4 | Underground water observation hole No.3-5 |
|--------------------------|--|--|--|---|---|---|---|---|--|---|---|---|
| Date of sampling | Dec 19, 2013 | Dec 19, 2013 | / | / | / | / | / | Dec 21, 2013 | / | / | / | / |
| Time of sampling | 11:05 AM | 9:45 AM | / | / | / | / | / | 9:07 AM | / | / | / | / |
| Chloride (unit: ppm) | - | - | / | / | / | / | / | 580 | / | / | / | / |
| Cs-134 (Approx. 2 years) | ND(1.8) | ND(0.48) | / | / | / | / | / | 0.63 | / | / | / | / |
| Cs-137 (Approx.30 years) | ND(1.3) | ND(0.50) | / | / | / | / | / | 1.9 | / | / | / | / |
| The other γ | Co-60 (Approx. 5 years) | 0.61 | ND | / | / | / | / | ND | / | / | / | / |
| | Sb-125 (Approx. 3 years) | 4.6 | 1.4 | / | / | / | / | ND | / | / | / | / |
| Gross β | 1,900,000 | 27 | / | / | / | / | / | 120 | / | / | / | / |
| H-3 (Approx. 12 years) | 28,000 | 18,000 | / | / | / | / | / | 760 | / | / | / | / |
| Sr-90 (Approx. 29 years) | - | - | / | / | / | / | / | - | / | / | / | / |

* Data announced this time is provided in a thick-frame. The other data was announced on December 20 and 21.

* "ND" indicates that the measurement result is below the detection limit, and the detection limit of each nuclide is provided in parentheses.

* "-" indicates that the measurement was out of range.

Detailed Analysis Results in the Port of Fukushima Daiichi NPS, around Discharge Channel and Bank Protection (2/4) Underground Water Obtained at Bank Protection

Unit: Bq/L (exclude chloride)

| | Underground water observation hole No.0-1 | Underground water observation hole No.0-1-1 | Underground water observation hole No.0-1-2 | Underground water observation hole No.0-2 | Underground water observation hole No.0-3-1 | Underground water observation hole No.0-3-2 | Underground water observation hole No.0-4 | Underground water observation hole No.1 | Underground water observation hole No.1-8 | Underground water observation hole No.1-9 | Underground water observation hole No.1-11 | Underground water observation hole No.1-12 | Underground water observation hole No.1-14 |
|--------------------------|---|---|---|---|---|---|---|---|---|---|--|--|--|
| Date of sampling | / | / | / | / | / | / | / | Dec 23, 2013 | Dec 23, 2013 | / | Dec 23, 2013 | Dec 23, 2013 | Dec 23, 2013 |
| Time of sampling | / | / | / | / | / | / | / | 9:43 AM | 10:15 AM | / | 9:48 AM | 10:15 AM | 10:35 AM |
| Chloride (unit: ppm) | / | / | / | / | / | / | / | - | - | / | - | - | - |
| Cs-134 (Approx. 2 years) | / | / | / | / | / | / | / | ND(0.48) | 37 | / | 0.45 | 4.3 | ND(0.46) |
| Cs-137 (Approx.30 years) | / | / | / | / | / | / | / | ND(0.54) | 85 | / | 0.93 | 10 | 1.2 |
| The other γ | Mn-54 (Approx. 310 days) | / | / | / | / | / | / | ND | 8.0 | / | ND | ND | ND |
| | Co-60 (Approx. 5 years) | / | / | / | / | / | / | ND | 0.63 | / | ND | ND | ND |
| | Ru-106 (Approx. 370 days) | / | / | / | / | / | / | 3.4 | ND | / | ND | ND | ND |
| Gross β | / | / | / | / | / | / | 490 | 29,000 | / | ND(24) | 65 | 250 | |
| H-3 (Approx. 12 years) | / | / | / | / | / | / | Under analysis | Under analysis | / | Under analysis | Under analysis | Under analysis | |
| Sr-90 (Approx. 29 years) | / | / | / | / | / | / | - | - | / | - | - | - | |

| | Underground water observation hole No.1-16 | Underground water observation hole No.1-17 | Groundwater pumped up from the well point (between Unit 1 and 2) | Underground water observation hole No.2 | Underground water observation hole No.2-3 | Underground water observation hole No.2-5 | Underground water observation hole No.2-6 | Underground water observation hole No.2-7 | Groundwater pumped up from the well point (between Unit 2 and 3) | Underground water observation hole No.3 | Underground water observation hole No.3-4 | Underground water observation hole No.3-5 |
|--------------------------|--|--|--|---|---|---|---|---|--|---|---|---|
| Date of sampling | Dec 23, 2013 | Dec 23, 2013 | Dec 23, 2013 | / | / | / | / | Dec 23, 2013 | / | / | / | / |
| Time of sampling | 10:48 AM | 9:25 AM | 10:12 AM | / | / | / | / | 9:25 AM | / | / | / | / |
| Chloride (unit: ppm) | - | - | - | / | / | / | / | 550 | / | / | / | / |
| Cs-134 (Approx. 2 years) | ND(3.6) | ND(0.47) | ND(1.1) | / | / | / | / | ND(0.39) | / | / | / | / |
| Cs-137 (Approx.30 years) | ND(2.3) | ND(0.48) | 1.4 | / | / | / | / | 1.2 | / | / | / | / |
| The other γ | Co-60 (Approx. 5 years) | ND | 0.55 | ND | / | / | / | ND | / | / | / | / |
| | | | | | / | / | / | | / | / | / | / |
| Gross β | 1,800,000 | 130 | 220,000 | / | / | / | / | 31 | / | / | / | / |
| H-3 (Approx. 12 years) | Under analysis | Under analysis | Under analysis | / | / | / | / | Under analysis | / | / | / | / |
| Sr-90 (Approx. 29 years) | - | - | - | / | / | / | / | - | / | / | / | / |

* "ND" indicates that the measurement result is below the detection limit, and the detection limit of each nuclide is provided in parentheses.

* "-" indicates that the measurement was out of range.

Detailed Analysis Results in the Port of Fukushima Daiichi NPS, around Discharge Channel and Bank Protection (Sampling Locations of Seawater)

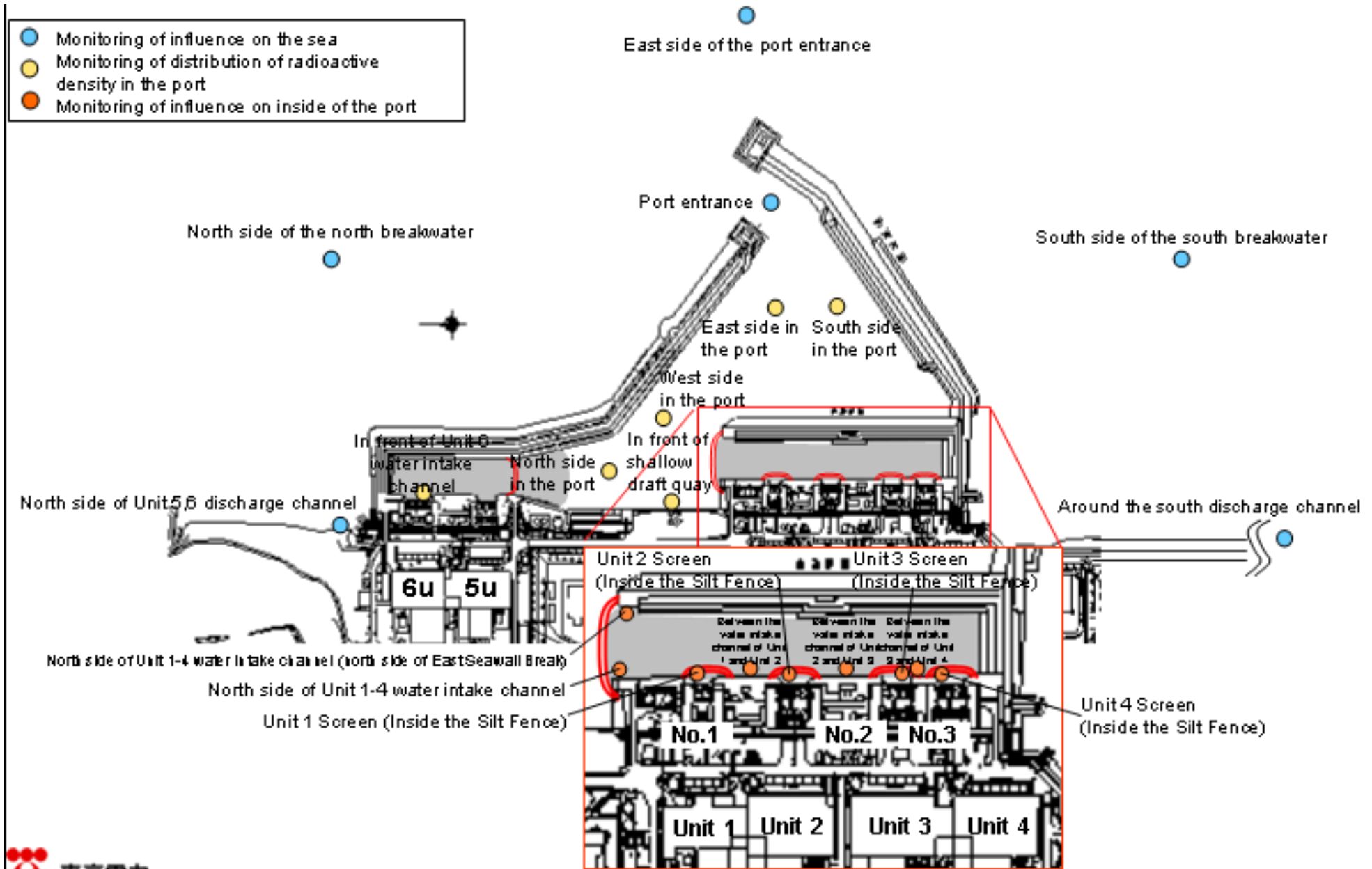

Detailed Analysis Results in the Port of Fukushima Daiichi NPS, around Discharge Channel and Bank Protection (3/4) Seawater

Unit: Bq/L

| | 1F, North side of Unit 5,6 discharge channel | 1F, In front of Unit 6 water intake channel | 1F, In front of shallow draft quay | 1F, North side of Unit 1-4 water intake channel | 1F, North side of Unit 1-4 water intake channel (north side of East Seawall Break) | 1F, Unit 1 Screen (Inside the Silt Fence) | 1F, Between the water intake channel of Unit 1 and Unit 2 (surface layer) | 1F, Between the water intake channel of Unit 1 and Unit 2 (lower layer) | 1F, Unit 2 Screen (Inside the Silt Fence) | 1F, Between the water intake channel of Unit 2 and Unit 3 | 1F, Unit 3 Screen (Inside the Silt Fence) | 1F, Between the water intake channel of Unit 3 and Unit 4 | Density Limit Specified by the Reactor Regulation * | WHO Guidelines for drinking-water quality |
|--------------------------|--|---|------------------------------------|---|--|---|---|---|---|---|---|---|---|---|
| Date of Sampling | / | / | / | / | / | / | / | / | / | Dec 21, 2013 | / | / | | |
| Time of sampling | / | / | / | / | / | / | / | / | / | 7:12 AM | / | / | | |
| Cs-134(Approx. 2 years) | / | / | / | / | / | / | / | / | / | 52 | / | / | 60 | 10 |
| Cs-137(Approx.30 years) | / | / | / | / | / | / | / | / | / | 110 | / | / | 90 | 10 |
| Gross β | / | / | / | / | / | / | / | / | / | 230 | / | / | | |
| H-3 (Approx. 12 years) | / | / | / | / | / | / | / | / | / | 300 | / | / | 60,000 | 10,000 |
| Sr-90 (Approx. 29 years) | / | / | / | / | / | / | / | / | / | - | / | / | 30 | 10 |

Unit: Bq/L

| | 1F, Unit 4 Screen (Inside the Silt Fence) | 1F, Around the south discharge channel | 1F, Port entrance | 1F, East side in the port | 1F, West side in the port | 1F, North side in the port | 1F, South side in the port | North side of the north breakwater | Northeast side of the port entrance | East side of the port entrance | Southeast side of the port entrance | South side of the south breakwater | Density Limit Specified by the Reactor Regulation * | WHO Guidelines for drinking-water quality |
|--------------------------|---|--|-------------------|---------------------------|---------------------------|----------------------------|----------------------------|------------------------------------|-------------------------------------|--------------------------------|-------------------------------------|------------------------------------|---|---|
| Date of Sampling | / | / | Dec 17, 2013 | Dec 17, 2013 | Dec 17, 2013 | Dec 17, 2013 | Dec 17, 2013 | / | / | / | / | / | | |
| Time of sampling | / | / | 7:34 AM | 7:42 AM | 7:48 AM | 7:51 AM | 7:39 AM | / | / | / | / | / | | |
| Cs-134(Approx. 2 years) | / | / | ND(1.6) | ND(1.3) | ND(1.8) | ND(1.6) | ND(1.2) | / | / | / | / | / | 60 | 10 |
| Cs-137(Approx.30 years) | / | / | ND(1.5) | ND(1.2) | 5.4 | 5.4 | ND(1.0) | / | / | / | / | / | 90 | 10 |
| Gross β | / | / | ND(16) | ND(16) | 28 | 21 | ND(16) | / | / | / | / | / | | |
| H-3 (Approx. 12 years) | / | / | ND(1.8) | 2.4 | 19 | 14 | 2.1 | / | / | / | / | / | 60,000 | 10,000 |
| Sr-90 (Approx. 29 years) | / | / | - | - | - | - | - | / | / | / | / | / | 30 | 10 |

* Data announced this time is provided in a thick-frame. The other data was announced on December 18 and 21.

* "ND" indicates that the measurement result is below the detection limit, and the detection limit of each nuclide is provided in parentheses.

* "-" indicates that the measurement was out of range.

* Density Limit Specified by the Rule for the Installation, Operation, etc. of Commercial Nuclear Power Reactors (the density limit in the water outside the surrounding monitored areas is provided in section 6 of Appendix 2 [the amount is converted from Bq/cm³ to Bq/L]).

Detailed Analysis Results in the Port of Fukushima Daiichi NPS, around Discharge Channel and Bank Protection (4/4) Seawater

Unit: Bq/L

| | 1F, North side of Unit 5,6 discharge channel | 1F, In front of Unit 6 water intake channel | 1F, In front of shallow draft quay | 1F, North side of Unit 1-4 water intake channel | 1F, North side of Unit 1-4 water intake channel (north side of East Seawall Break) | 1F, Unit 1 Screen (Inside the Silt Fence) | 1F, Between the water intake channel of Unit 1 and Unit 2 (surface layer) | 1F, Between the water intake channel of Unit 1 and Unit 2 (lower layer) | 1F, Unit 2 Screen (Inside the Silt Fence) | 1F, Between the water intake channel of Unit 2 and Unit 3 | 1F, Unit 3 Screen (Inside the Silt Fence) | 1F, Between the water intake channel of Unit 3 and Unit 4 | Density Limit Specified by the Reactor Regulation * | WHO Guidelines for drinking-water quality |
|--------------------------|--|---|------------------------------------|---|--|---|---|---|---|---|---|---|---|---|
| Date of Sampling | Dec 23, 2013 | Dec 23, 2013 | Dec 23, 2013 | / | Dec 23, 2013 | Dec 23, 2013 | / | / | Dec 23, 2013 | Dec 23, 2013 | Dec 23, 2013 | Dec 23, 2013 | | |
| Time of sampling | 7:15 AM | 6:55 AM | 6:34 AM | / | 7:01 AM | 6:41 AM | / | / | 6:48 AM | 6:43 AM | 6:52 AM | 6:55 AM | | |
| Cs-134(Approx. 2 years) | ND(0.62) | ND(2.0) | 2.7 | / | 15 | 44 | / | / | 36 | 34 | 23 | 21 | 60 | 10 |
| Cs-137(Approx.30 years) | 0.99 | 2.1 | 4.1 | / | 42 | 110 | / | / | 91 | 85 | 53 | 46 | 90 | 10 |
| Gross β | 12 | ND(19) | 26 | / | 93 | 360 | / | / | 290 | 260 | 110 | 100 | | |
| H-3 (Approx. 12 years) | Under analysis | Under analysis | Under analysis | / | Under analysis | Under analysis | / | / | Under analysis | Under analysis | Under analysis | Under analysis | 60,000 | 10,000 |
| Sr-90 (Approx. 29 years) | - | - | - | / | - | - | / | / | - | - | - | - | 30 | 10 |

Unit: Bq/L

| | 1F, Unit 4 Screen (Inside the Silt Fence) | 1F, Around the south discharge channel | 1F, Port entrance | 1F, East side in the port | 1F, West side in the port | 1F, North side in the port | 1F, South side in the port | North side of the north breakwater | Northeast side of the port entrance | East side of the port entrance | Southeast side of the port entrance | South side of the south breakwater | Density Limit Specified by the Reactor Regulation * | WHO Guidelines for drinking-water quality |
|--------------------------|---|--|-------------------|---------------------------|---------------------------|----------------------------|----------------------------|------------------------------------|-------------------------------------|--------------------------------|-------------------------------------|------------------------------------|---|---|
| Date of Sampling | Dec 23, 2013 | / | / | / | / | / | / | / | / | / | / | / | | |
| Time of sampling | 6:54 AM | / | / | / | / | / | / | / | / | / | / | / | | |
| Cs-134(Approx. 2 years) | 27 | / | / | / | / | / | / | / | / | / | / | / | 60 | 10 |
| Cs-137(Approx.30 years) | 57 | / | / | / | / | / | / | / | / | / | / | / | 90 | 10 |
| Gross β | 130 | / | / | / | / | / | / | / | / | / | / | / | | |
| H-3 (Approx. 12 years) | Under analysis | / | / | / | / | / | / | / | / | / | / | / | 60,000 | 10,000 |
| Sr-90 (Approx. 29 years) | - | / | / | / | / | / | / | / | / | / | / | / | 30 | 10 |

* "ND" indicates that the measurement result is below the detection limit, and the detection limit of each nuclide is provided in parentheses.

* "-" indicates that the measurement was out of range.

* Density Limit Specified by the Rule for the Installation, Operation, etc. of Commercial Nuclear Power Reactors (the density limit in the water outside the surrounding monitored areas is provided in section 6 of Appendix 2 [the amount is converted from Bq/cm³ to Bq/L]).

<Reference> The Highest Dose Until the Previous Measurement (Groundwater Obtained at Bank Protection)

Unit: Bq/L

| | Groundwater observation hole No.0-1 | Groundwater observation hole No.0-1-1 | Groundwater observation hole No.0-1-2 | Groundwater observation hole No.0-2 | Groundwater observation hole No.0-3-1 | Groundwater observation hole No.0-3-2 | Groundwater observation hole No.0-4 | Groundwater observation hole No.1 | Groundwater observation hole No.1-1* | Groundwater observation hole No.1-2* | Groundwater observation hole No.1-3* | Groundwater observation hole No.1-4* | Groundwater observation hole No.1-5* |
|--------------------------|-------------------------------------|---------------------------------------|---------------------------------------|-------------------------------------|---------------------------------------|---------------------------------------|-------------------------------------|-----------------------------------|--------------------------------------|--------------------------------------|--------------------------------------|--------------------------------------|--------------------------------------|
| Cs-134 (Approx. 2 years) | 7.6 [12/15] | ND | ND | 0.61 [10/13] | 0.44 [11/24] | ND | ND | 13 [8/29] | 1.9 [7/8] | 11,000 [7/9] | 10 [9/2] | 1.5 [7/8] | 310 [8/5] |
| Cs-137 (Approx.30 years) | 17 [12/15] | 0.58 [12/7] | 0.51 [11/17] | 1.6 [10/13] | 0.86 [11/20] | 0.54 [12/6] | 0.49 [12/1] | 31 [8/29] | 3.6 [7/8] | 22,000 [7/9] | 24 [9/2] | 3.6 [7/8] | 650 [8/5] |
| The other y | Ru-106 (Approx. 370 days) | ND | ND | ND | ND | ND | ND | 26 [5/24] | 7.9 [7/8] | 160 [8/15] | 17 [7/22] [8/8] | 3.1 [8/8] | ND |
| | Mn-54 (Approx. 310 days) | ND | ND | ND | ND | ND | ND | ND | 1.0 [7/5] | 62 [7/5] | ND | ND | ND |
| | Co-60 (Approx. 5 years) | ND | ND | ND | ND | ND | ND | 0.50 [7/19] | ND | 3.1 [7/8] | ND | ND | ND |
| | Sb-125 (Approx. 3 years) | ND | ND | ND | ND | ND | ND | 1.7 [7/11] | ND | 250 [7/15] | 1.4 [7/12] [8/26] | ND | 12 [8/8] |
| Gross β | 300 [8/22] | 21 [12/7] | 21 [11/10] | 87 [10/13] | ND | 67 ² [12/11] | ND | 1,900 [5/24] | 4,400 [7/8] | 900,000 [7/5] [7/9] | 160,000 [8/12] [8/15] | 380 [8/19] | 56,000 [8/5] |
| H-3 (Approx. 12 years) | 45,000 [8/29] | 18,000 [12/7] | 74,000 [12/15] | 2,500 [12/15] | ND | 69000 ² [12/17] [12/19] | 20,000 [12/1] [12/8] [12/15] | 500,000 [5/24] [6/7] | 630,000 [7/8] | 430,000 [9/16] | 290,000 [7/12] | 98,000 [7/11] | 72,000 [8/15] |
| Sr-90(Approx. 29 years) | Under analysis | Under analysis | Under analysis | Under analysis | Under analysis | Under analysis | Under analysis | 1,200 [6/7] | Under analysis | Under analysis | Under analysis | Under analysis | Under analysis |

Unit: Bq/L

| | Groundwater observation hole No.1-8 | Groundwater observation hole No.1-9 | Groundwater observation hole No.1-11 | Groundwater observation hole No.1-12 | Groundwater observation hole No.1-14 | Groundwater observation hole No.1-16 | Groundwater observation hole No.1-17 | Groundwater pumped up from the well point (between Unit 1 and 2) |
|--------------------------|-------------------------------------|-------------------------------------|--------------------------------------|--------------------------------------|--------------------------------------|--------------------------------------|--------------------------------------|--|
| Cs-134 (Approx. 2 years) | 47 [11/25] | 170 [9/3] | 0.94 [10/31] | 74 [10/21] | 1.2 [11/14] | 3.1 ² [12/13] | <u>1.2</u> [12/5] | 110 [9/23] |
| Cs-137 (Approx.30 years) | 110 [11/25] | 380 [9/3] | 2.2 [12/2] | 170 [10/21] | 2.3 [11/21] | 3.4 [10/10] | 0.66 [12/12] | 250 [9/23] |
| The other y | Ru-106 (Approx. 370 days) | ND | ND | 5.4 [10/28] | ND | 9.2 [10/28] | 4.1 [12/12] | 25 [9/2] |
| | Mn-54 (Approx. 310 days) | 9.7 [12/16] | ND | ND | ND | ND | ND | ND |
| | Co-60 (Approx. 5 years) | 0.62 [12/16] | ND | ND | 0.51 [10/24] | ND | 0.9 [11/7] | 0.61 [11/25] |
| | Sb-125 (Approx. 3 years) | ND | ND | ND | 61 [10/21] | ND | 11 [12/5] | 2.1 [11/25] |
| Gross β | 31,000 [12/16] | 2,100 [11/17] | 72 [10/3] | 730 [10/21] | 240 [12/19] | 1,900,000 [12/19] | <u>130</u> [12/2] | 700,000 [9/23] |
| H-3 (Approx. 12 years) | 9,100 [12/9] | 860 [11/14] | 85,000 [9/13] | 440,000 [10/31] | 11,000 [11/25] | 43,000 [9/26] | 16,000 [12/5] [12/9] [12/12] [12/16] | 460,000 [8/19] |
| Sr-90(Approx. 29 years) | Under analysis | Under analysis | Under analysis | Under analysis [10/21] | Under analysis | Under analysis | Under analysis | - |

Unit: Bq/L

| | Groundwater observation hole No.2 | Groundwater observation hole No.2-1* | Groundwater observation hole No.2-3 | Groundwater observation hole No.2-5 ¹ | Groundwater observation hole No.2-6 | Groundwater observation hole No.2-7 | Groundwater pumped up from the well point (between Unit 2 and 3) | Groundwater observation hole No.3 | Groundwater observation hole No.3-1* | Groundwater observation hole No.3-4 | Groundwater observation hole No.3-5 |
|--------------------------|-----------------------------------|--------------------------------------|-------------------------------------|--|-------------------------------------|-------------------------------------|--|-----------------------------------|--------------------------------------|-------------------------------------|-------------------------------------|
| Cs-134 (Approx. 2 years) | 0.50 [7/9] | 0.66 [9/1] | ND | 5.2 [12/4] | 0.56 [10/30] | 1.3 [11/21] | 1.1 [12/12] | 3.5 [7/25] | 1.2 [7/25] [8/8] | 1.8 [10/30] | 29 [12/18] |
| Cs-137 (Approx.30 years) | 1.2 [7/11] [8/1] | 1.1 [8/29] [9/1] | 0.49 [12/6] | 12 [12/4] | 0.61 [10/13] | 3.1 [11/21] | <u>2.4</u> [12/7] | 5.9 [8/8] | 2.6 [8/1] | <u>4.3</u> [11/27] | 74 [12/18] |
| The other y | Ru-106 (Approx. 370 days) | ND | ND | ND | ND | ND | ND | ND | ND | ND | - |
| | Mn-54 (Approx. 310 days) | ND | ND | 0.29 [12/6] | 0.87 [12/4] | ND | ND | ND | ND | 0.54 [10/30] | - |
| | Co-60 (Approx. 5 years) | ND | ND | ND | ND | ND | ND | ND | ND | ND | - |
| | Sb-125 (Approx. 3 years) | ND | ND | ND | 26 [9/29] | ND | ND | ND | 1.1 [9/5] | ND | ND |
| Gross β | 1,700 [7/8] | 380 [7/29] | 1,500 [12/6] | 48,000 [9/29] | 3,200 [12/5] | 270 [12/20] | 240,000 [12/12] | 1,400 [7/11] | 180 [8/1] | ND | 43 [12/18] |
| H-3 (Approx. 12 years) | 870 [12/8] | 440 [8/26] | 1,700 [12/6] | 6,300 [12/4] | 1,200 [11/24] [11/27] | 1,000 [11/21] [12/4] | 5,100 [12/6] | 3,200 [2012/12] [12] | 460 [8/1] | 170 [9/18] | 160 [12/18] |
| Sr-90(Approx. 29 years) | 54 [5/31] | Under analysis | Under analysis | Under analysis | Under analysis | Under analysis | - | 8.3 [2012/12] [12] | Under analysis | Under analysis | - |

*1 The analysis result of No.2-5 obtained on September 29 is the reference value, since we could not sample groundwater by a regular procedure

*2 Since the water of No.3-5 was highly turbid, only chloride, Gross β and tritium were analyzed as a reference

* "ND" indicates that the measurement result is below the detection limit.

* Date of sampling is provided in parentheses.

* "*" is provided next to the name of the holes where the sampling could not be performed due to the chemical injection of ground improvement.

The underlined part was corrected on January 10, 2014.

<Reference> The Highest Dose Until the Previous Measurement* (Seawater)

Unit: Bq/L

| | 1F, North side of Unit 5,6 discharge channel | 1F, In front of Unit 6 water intake channel | 1F, In front of shallow draft quay | 1F, North side of Unit 1-4 water intake channel | 1F, North side of Unit 1-4 water intake channel (north side of East Seawall Break) | 1F, Unit 1 Screen (Inside the Silt Fence) | 1F, Between the water intake channel of Unit 1 and Unit 2 (surface layer) | 1F, Between the water intake channel of Unit 1 and Unit 2 (lower layer) | 1F, Unit 2 Screen (Inside the Silt Fence) | 1F, Between the water intake channel of Unit 2 and Unit 3 | 1F, Unit 3 Screen (Inside the Silt Fence) | 1F, Between the water intake channel of Unit 3 and Unit 4 |
|--------------------------|--|---|------------------------------------|---|--|---|---|---|---|---|---|---|
| Cs-134(Approx. 2 years) | 1.8 [6/21] | 2.8 [12/2] | 5.3 [8/5] | 89 [10/10] | 32 [10/11] | 73 [10/10] | 87 [10/10] | 93 [10/10] | 370 [10/9] | 46 [10/11] | 350 [7/15] | 28 [9/16] |
| Cs-137(Approx.30 years) | 3.3 [6/26] | 5.8 [12/2] | <u>8.6</u> [8/5] | 190 [10/10] | 73 [10/11] | 170 [10/10] | 200 [10/10] | 200 [10/10] | 830 [10/9] | 110 [10/11] | 770 [7/15] | <u>53</u> [12/16] |
| Gross β | 8.9 [12/16] | 46 [8/19] | <u>40</u> [7/3] | 1,400 [11/7] | 320 [8/12] | 740 [10/28] | 1,200 [12/8] | 450 [7/16] | 1,700 [10/9] | 480 [10/7] | 1,000 [7/15] | 390 [8/12] |
| H-3 (Approx. 12 years) | 8.6 [6/26] | 24 [8/19] | 340 [6/26] | 4,800 [11/7] | 510 [9/2] | 2,800 [10/28] | 2,800 [12/8] | 1,600 [9/1] | 2,100 [10/28] | 1,200 [10/7] | 410 [9/2] | 650 [8/12] |
| Sr-90 (Approx. 29 years) | 5.8 [6/26] | - | 7.4 [6/26] | Under analysis | Under analysis | Under analysis | Under analysis | Under analysis | Under analysis | Under analysis | Under analysis | Under analysis |

Unit: Bq/L

| | 1F, Unit 4 Screen (Inside the Silt Fence) | 1F, Around the south discharge channel | 1F, Port entrance | 1F, East side in the port | 1F, West side in the port | 1F, North side in the port | 1F, South side in the port | North side of the north breakwater | Northeast side of the port entrance | East side of the south breakwater | Southeast side of the north breakwater | South side of the south breakwater |
|--------------------------|---|--|-------------------|---------------------------|---------------------------|----------------------------|----------------------------|------------------------------------|-------------------------------------|-----------------------------------|--|------------------------------------|
| Cs-134(Approx. 2 years) | 62 [9/16] | ND | 2.7 [10/11] | 3.3 [10/17] | 3.9 [12/2] | 5.0 [12/2] | 3.5 [10/17] | ND | ND | ND | ND | ND |
| Cs-137(Approx.30 years) | 140 [9/16] | 3.0 [7/15] | 7.3 [10/11] | 9.0 [10/17] | 9.2 [12/2] | 8.4 [12/2] | 7.8 [10/17] | ND | ND | 1.6 [10/18] | ND | ND |
| Gross β | 360 [10/7] | 13 [12/16] | 69 [8/19] | 74 [8/19] | 60 [7/4] | 69 [8/19] | 79 [8/19] | ND | ND | ND | ND | ND |
| H-3 (Approx. 12 years) | 400 [8/12] [10/7] | 1.9 [11/25] | 68 [8/19] | 67 [8/19] | 59 [8/19] | 52 [8/19] | 60 [8/19] | 4.7 [8/14] | ND | 6.4 [10/8] | ND | ND |
| Sr-90 (Approx. 29 years) | Under analysis | 0.36 [6/26] | 3.5 [6/20] | Under analysis | Under analysis | - | - | - | - | - | - | - |

* The highest result announced in "Detailed Analysis Results in the Port of Fukushima Daiichi NPS, around Discharge Channel and Bank Protection" or the other handouts is provided.

As for "1F, North side of Unit 1-4 water intake channel", the data is obtained since January 14, 2013. For the other locations, the data is obtained since June 14.

* "ND" indicates that the measurement result is below the detection limit.

* Date of sampling is provided in parentheses.

* "-" indicates that the measurement was out of range.

The underlined part was corrected on January 10, 2014.

[Reference] Standard values

Unit: Bq/L

| | Cs-134 | Cs-137 | H-3 | Sr-90 |
|--|--------|--------|--------|-------|
| Density Limit Specified by the Rule for the Installation, Operation, etc. of Commercial Nuclear Power Reactors (the density limit in the water outside the surrounding monitored areas is provided in section 6 of Appendix 2) | 60 | 90 | 60,000 | 30 |
| WHO Guidelines for drinking-water quality | 10 | 10 | 10,000 | 10 |