

January 29, 2016  
Tokyo Electric Power Company

# Air Dose Rates inside the Buildings

Sampling Period

Unit 5: from November 1, 2015 to November 30, 2015

---

Fukushima Daiichi NPS

Unit 5 Reactor Building 1st Basement Floor

[mSv/h]

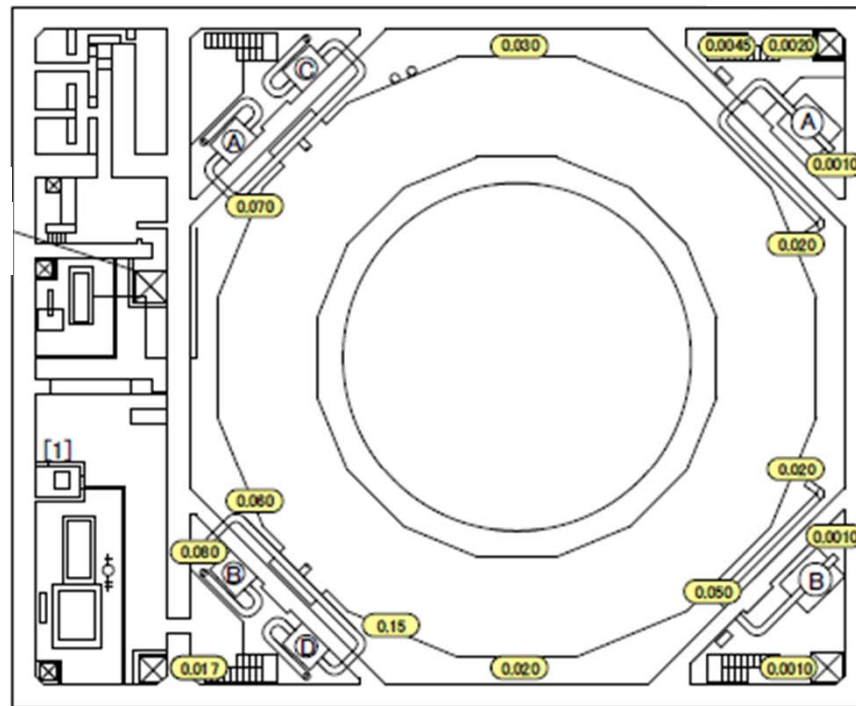

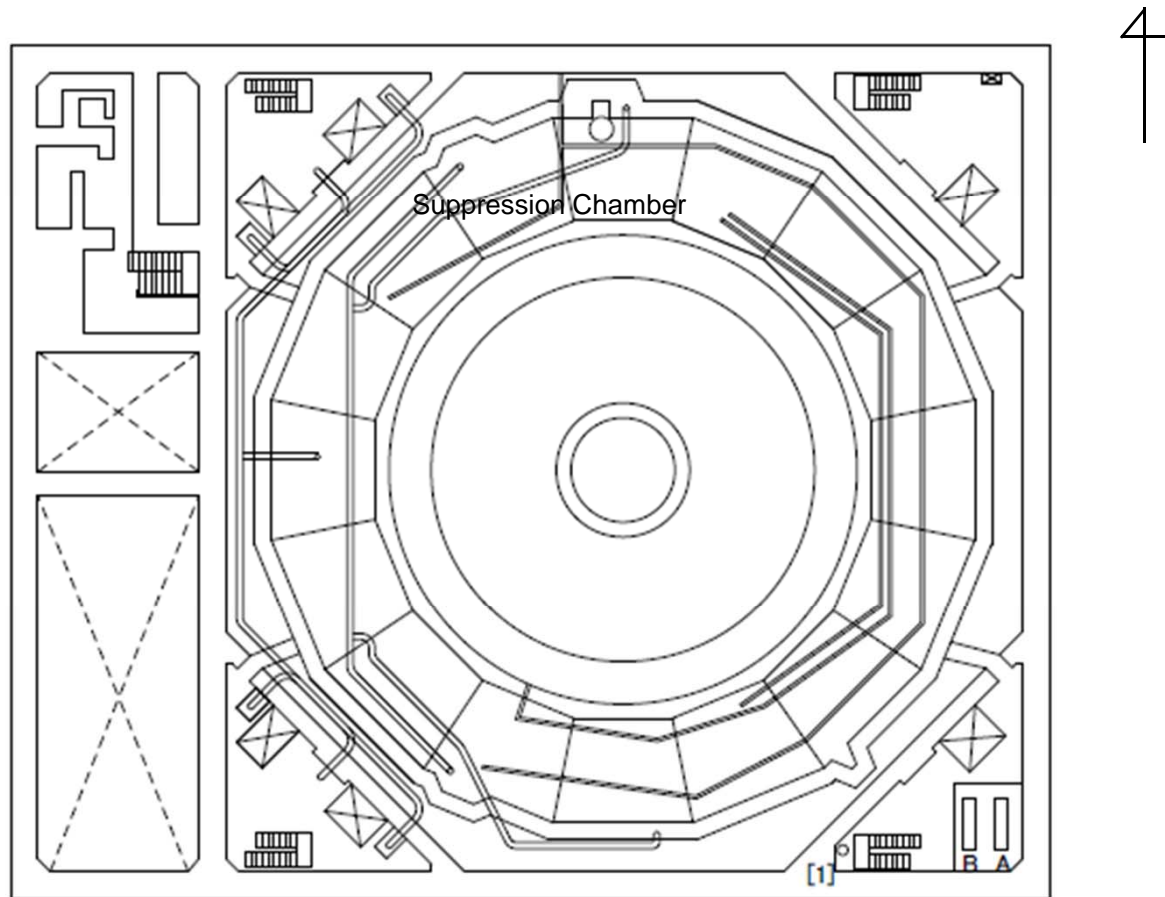

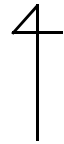
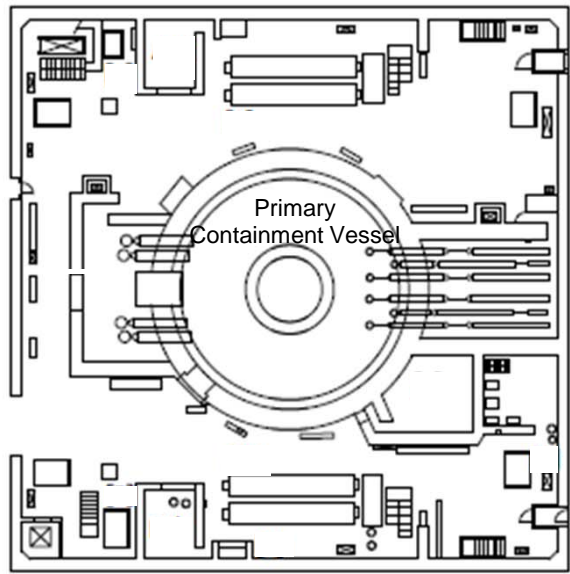

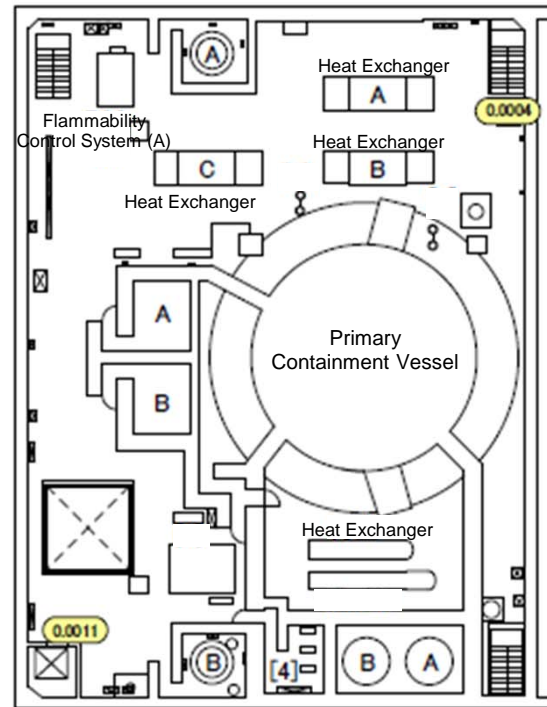
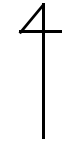

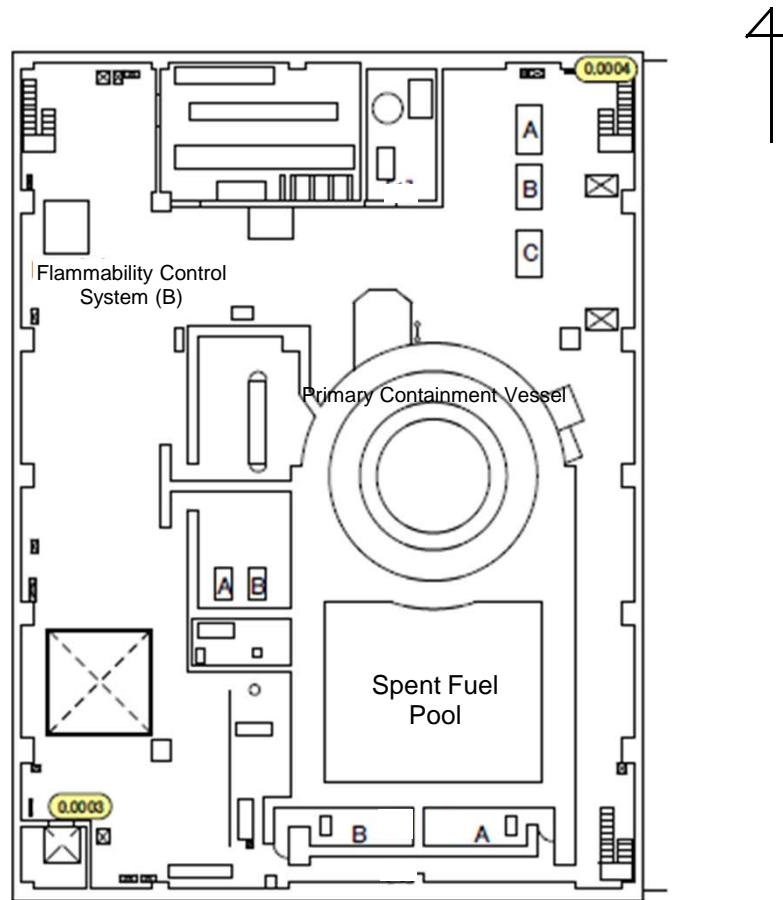

1F05RB004-00-01

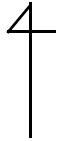
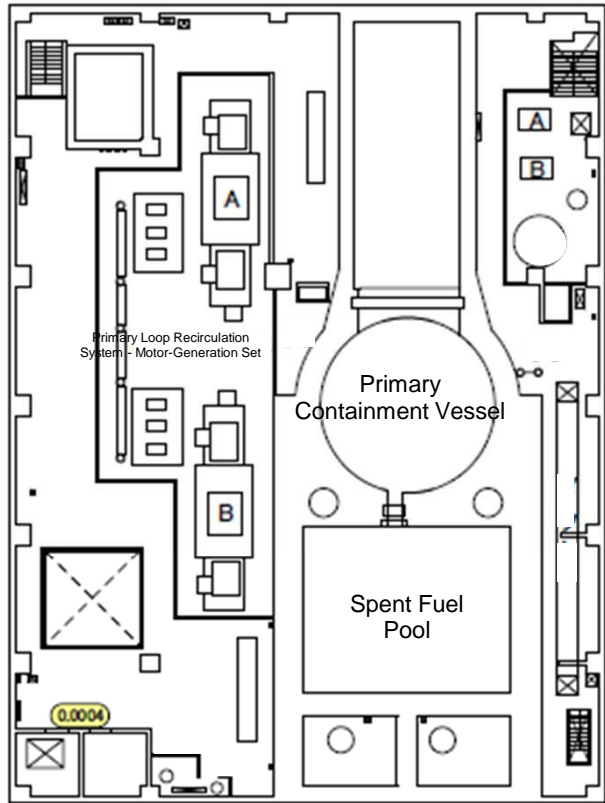
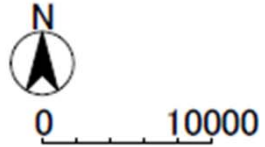

0.0004

Fukushima Daiichi NPS	Unit 5 Reactor Building 5th Floor	[mSv/h]
-----------------------	-----------------------------------	---------

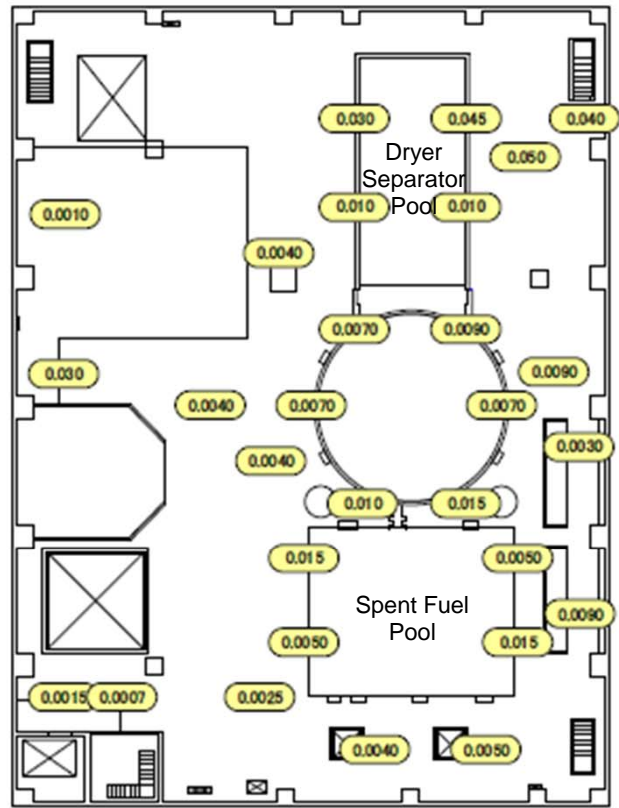



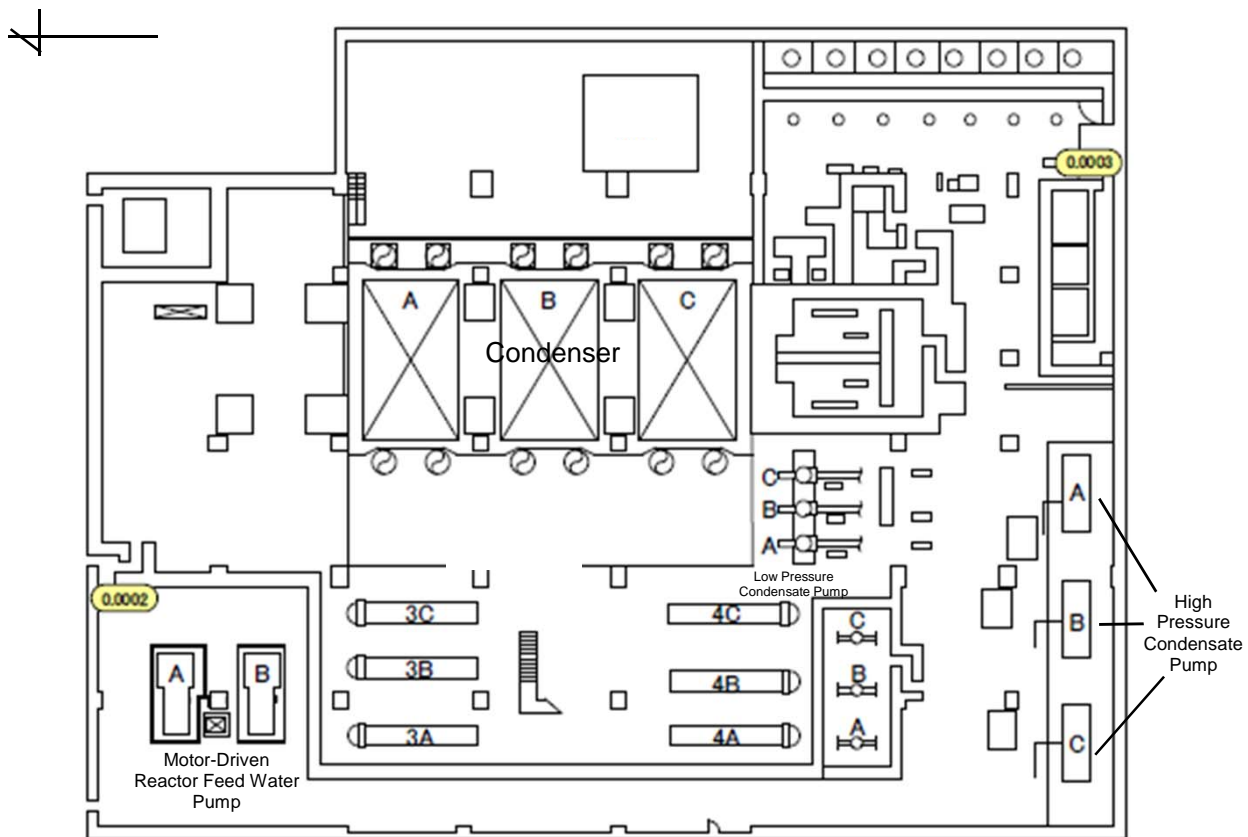

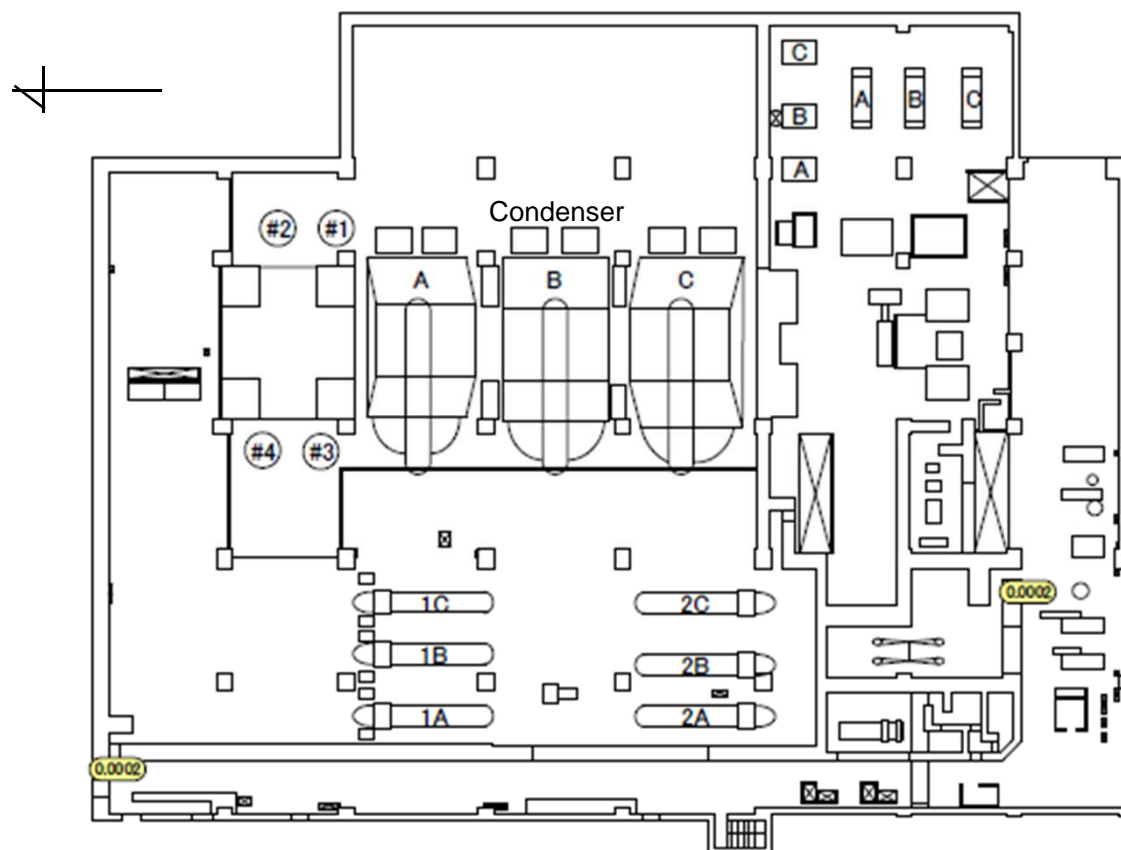

Fukushima Daiichi NPS	Unit 5 Turbine Building 2nd Floor	[mSv/h]
-----------------------	-----------------------------------	---------

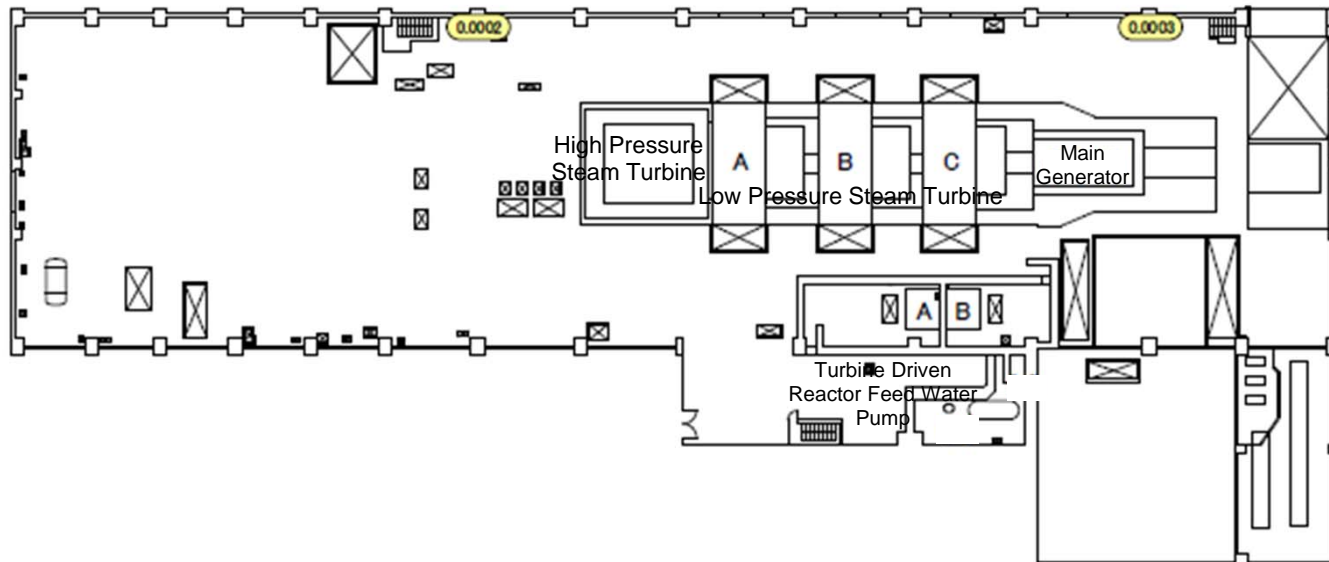
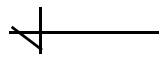

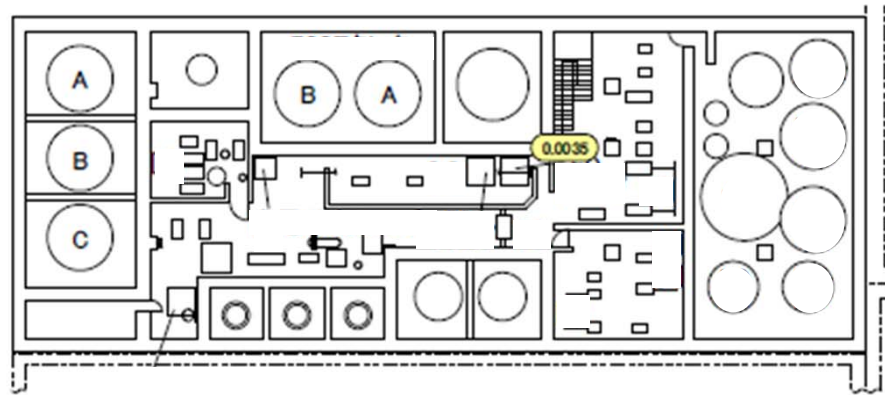

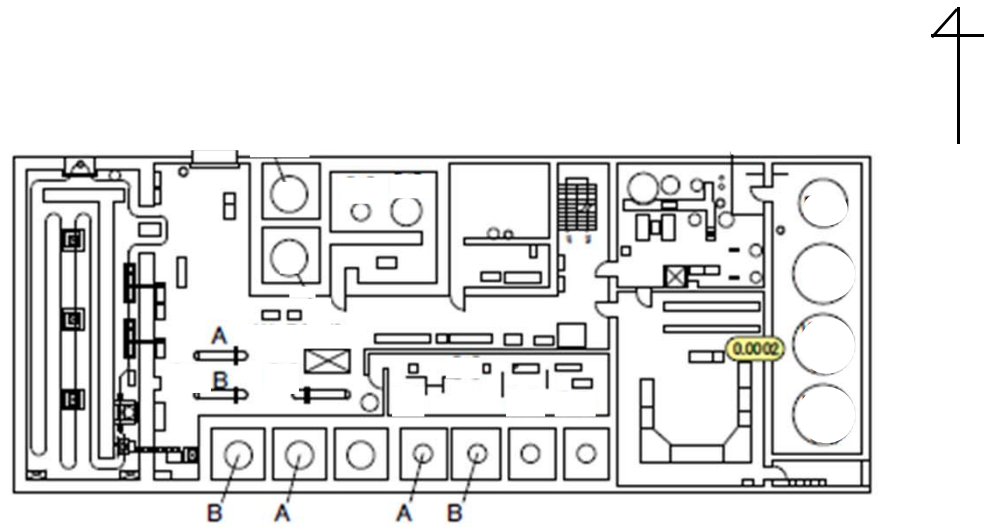

Fukushima Daiichi NPS

Unit 5 Radioactive Waste Treatment Facility 2nd Floor

[mSv/h]

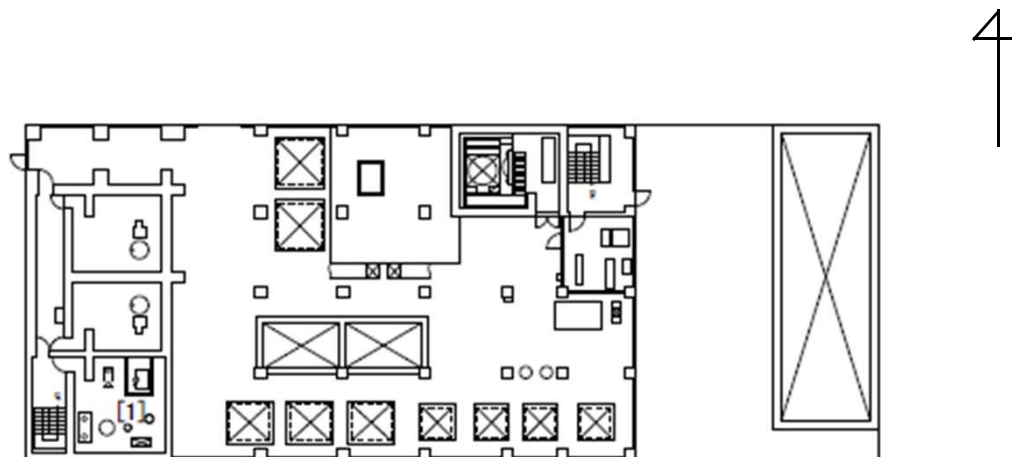

Fukushima Daiichi NPS

Units 5 and 6 Service Building 1st Floor

[mSv/h]

