

Relocation of the Control Room for Water Treatment Facilities into the Main Anti-Earthquake Building

<Reference>

May 17, 2016

Tokyo Electric Power Company Holdings, Inc.

The Control Room to monitor the operations of water treatment facilities before May 17, 2016



Picture taken on May 9, 2016

Relocated to the Central Control Room in the Main Anti-Earthquake Building



Picture taken on May 17, 2016



Picture taken on May 10, 2016



Picture taken on May 17, 2016

< Schedule >

- Relocation date
May 17, 2016
- System relocation time
From 9:02 a.m. to 10:35 a.m.

Source :
Tokyo Electric Power Company Holdings, Inc.

Relocation of the Control Room for Water Treatment Facilities into the Main Anti-Earthquake Building

- To centralize monitoring functions for Units 1-4 and water treatment facilities and to improve the work environment for the facility operators, the Control Room to monitor water treatment facilities was relocated to the Central Control Room in the Main Anti-Earthquake Building.
- To monitor and operate water treatment facilities from the Main Anti-Earthquake Building, new equipment was installed in the expanded area of the Central Control Room.
- The original monitoring equipment used before the relocation will remain as a backup and locked in a room. The rest of the area in the original Control Room will be used as a resting space for the onsite workers.

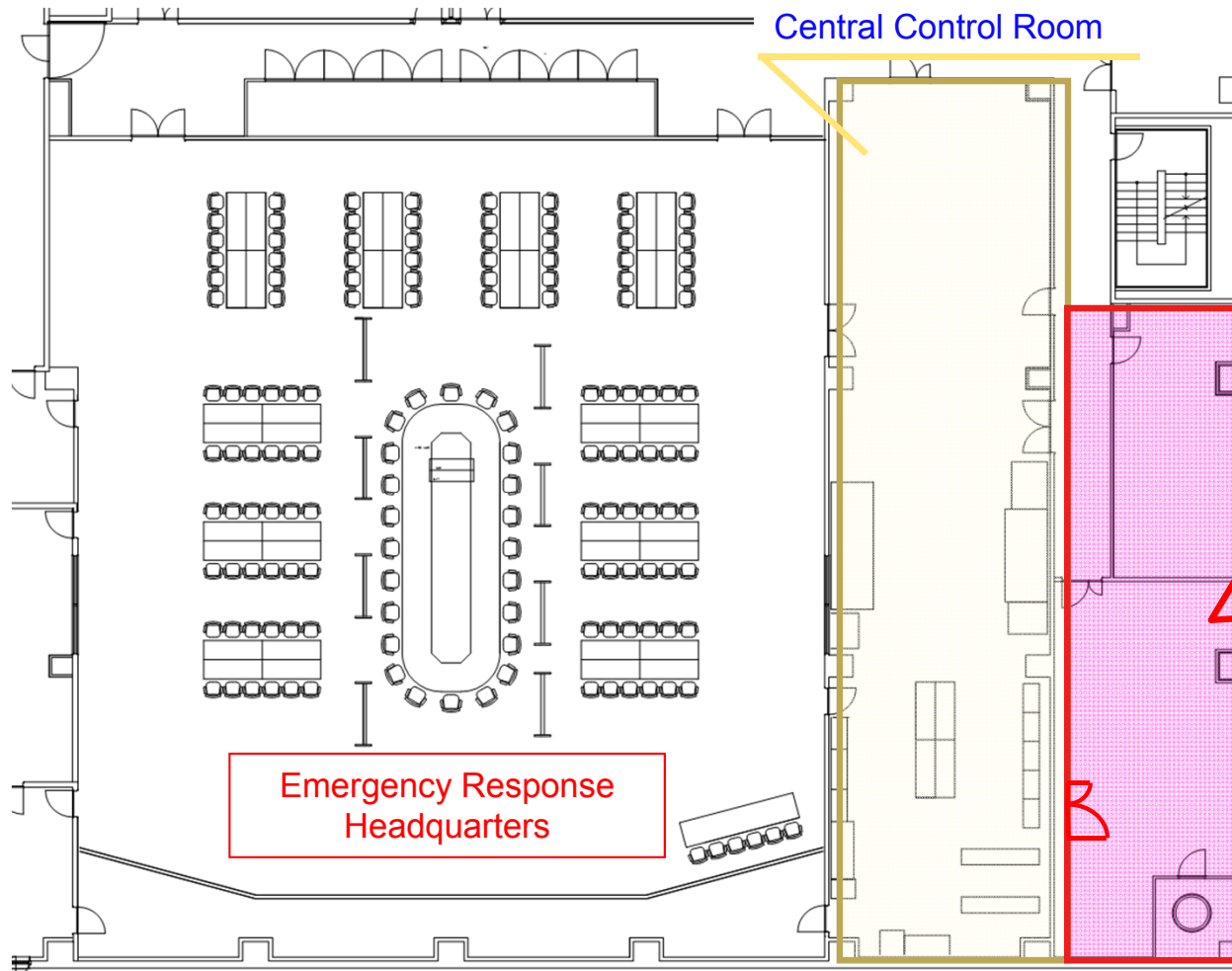

Expanded area to monitor and operate water treatment facilities

2nd floor of the Main Anti-Earthquake Building