

< Reference >

July 12, 2012

Tokyo Electric Power Company

# **Fukushima Daiichi Nuclear Power Station Unit 3 Reactor Building Basement Torus Room Investigation**



**東京電力**

---

# Investigation Outline

## Purpose

As water leak investigation and water stop measure implementation are planned for the area from PCV / Reactor Building to the Turbine Building, it is critical to understand the current condition of the Torus Room. A robot will investigate the inside of Torus Room with high radiation dose to obtain inputs to be leveraged for planning the water leak investigation and water stop measures.

## Investigation Items

The following will be done in the Torus Room in Unit 3 Reactor Building basement.

- Visual confirmation (Acquire photos and moving images)
- Dose rate measurement
- Collect sound samples in the Torus Room

The investigation was terminated as the cable communication of the survey runner was interrupted. However, visual confirmation and dose rate measurement were done almost as scheduled. Since the survey runner is still in the Torus Room, we have not been able to get the sound equipment back.

**Equipment:** Remote control robot (Survey runner)

**Members involved:** 11 TEPCO employees

**Investigation date:** Wednesday, July 11, 2012

11:03 AM: Survey runner entered R/B

2:09 PM: Cable communication of the survey runner interrupted

## Planned expose dose

Planned exposure dose [mSv]	Maximum exposure dose [mSv]	Number of people	Assigned roles
2	0.58	5	Robot operation, preparation, carrying the robot inside T/B
8	5.32	6	Carrying the robot through the triangle corner, opening doors

# Investigation Result (Dose Rate)

Point	Dose rate [mSv/h]	Remark	Point	Dose rate [mSv/h]	Remark
1	4		16	186	
2	18		17	234	
3	46		18	360	Side of the access hatch
4	100		19	169	
5	190		20	158	
6	173		21	164	
7	154	Side of the access hatch	22	186	
8	125		23	240	
9	176		24	193	
10	230				
11	192				
12	158				
13	176				
14	180				
15	179				

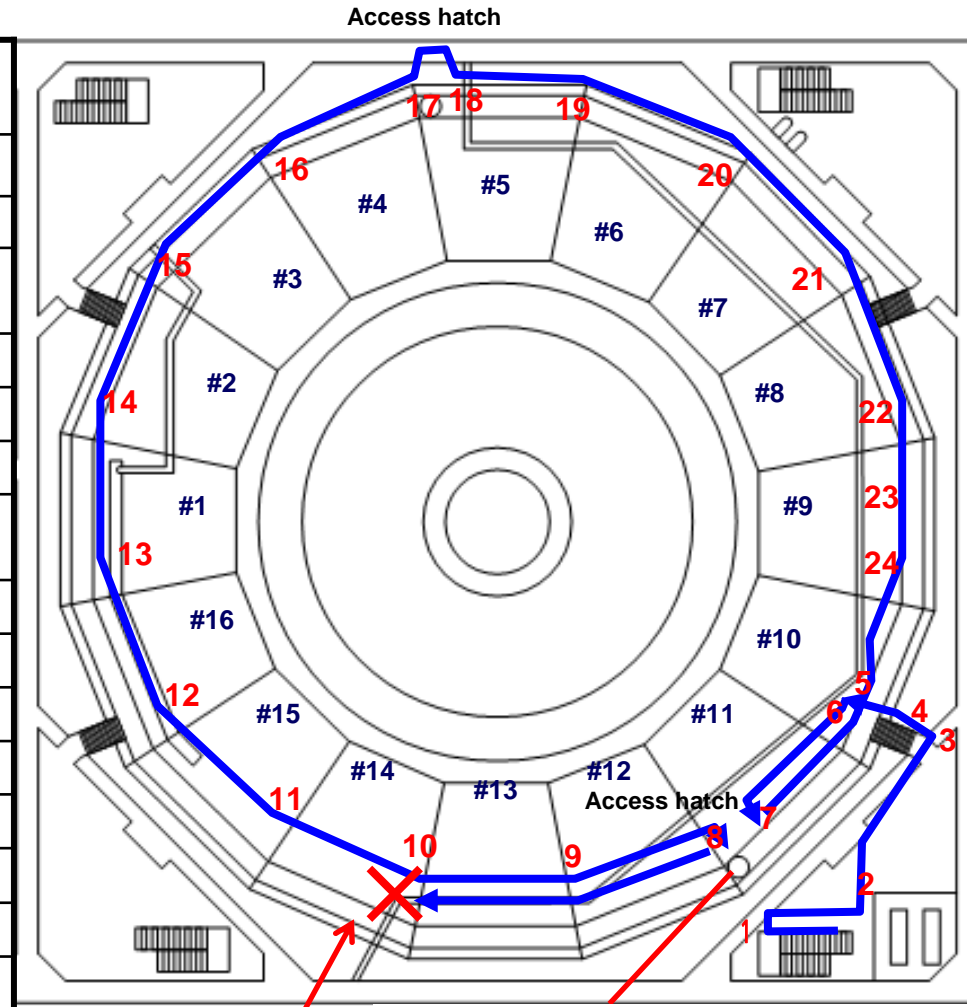

Location where the cable communication of survey runner was interrupted

The robot was unable to go through the side of the access hatch as it was too narrow

# Investigation Result (Images) 1/2

## Unit 3 R/B Basement

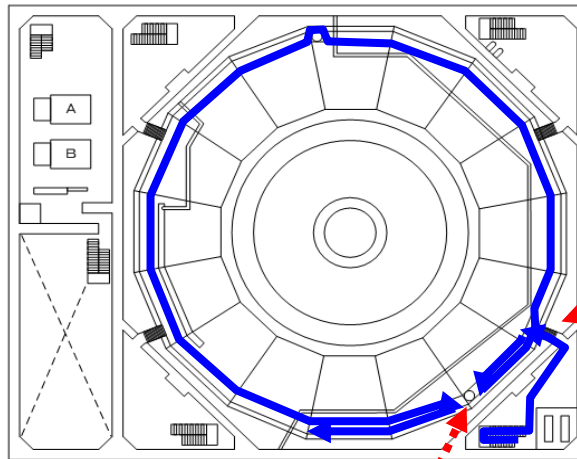

Torus Room entrance



Southeast side manhole

# Investigation Result (Images) 2/2

Unit 3 R/B Basement



North side manhole



PCV side



In front of Southwest stairway

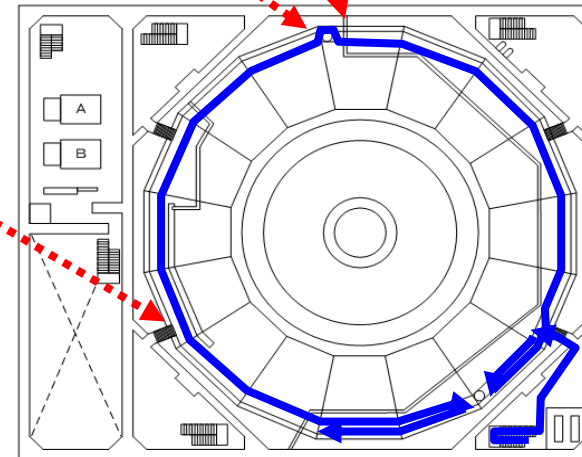

# Access Route for the Robot

R/B 1st floor

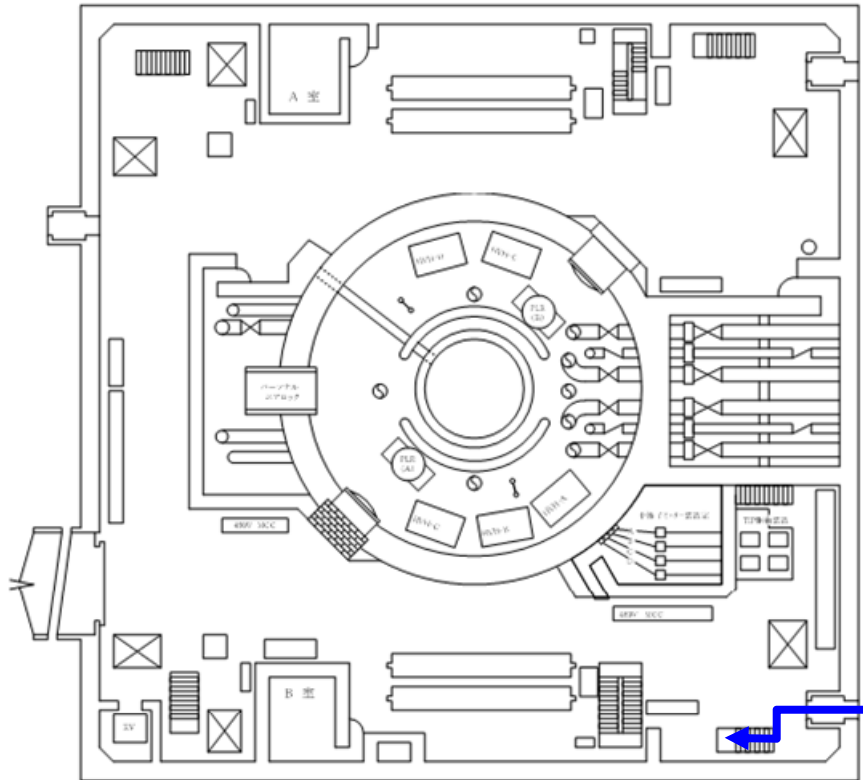

R/B Basement

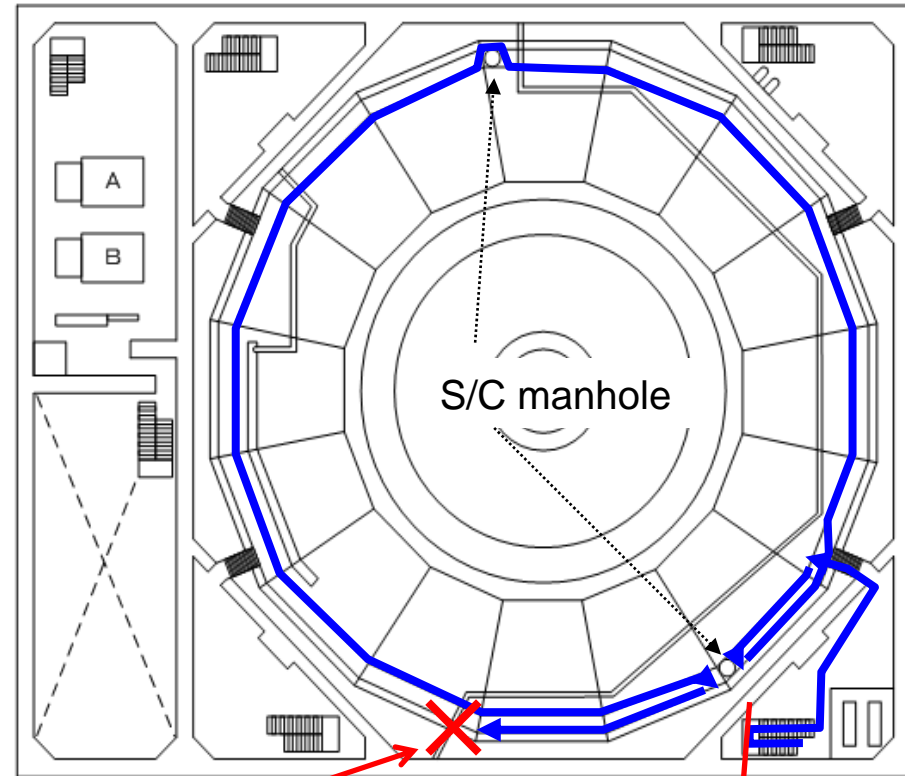

Location where the cable communication of survey runner was interrupted

The robot was unable to go through the side of the access hatch as it was too narrow

— : Access route