

Steel Framing Construction for the Cover to be Installed for Fuel Removal at Unit 4 at Fukushima Daiichi Nuclear Power Station: Completion of the First Layer of Steel Framing

The first layer of the steel framing for the cover to be installed for fuel removal at Unit 4 has been completed yesterday (January 14, 2013).

Outline

Date: January 8-14, 2013

Materials used: 6 columns and 7 beams (Total: 13)

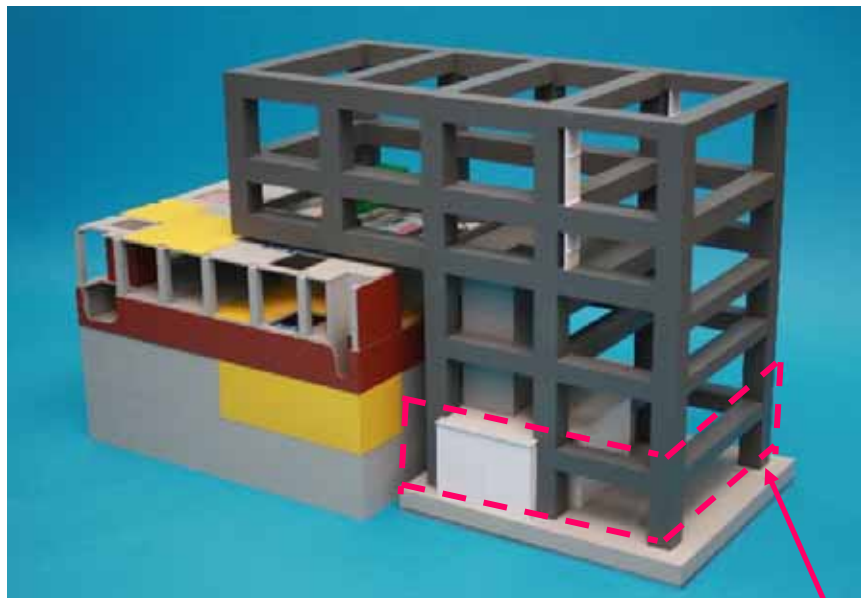

Simulated image of the cover to be installed for fuel removal



The first layer of steel framing completed

The first layer of steel framing has been completed