

## Progress of the Steel Frame Construction for the Cover to be Installed for Fuel Removal at Unit 4 at Fukushima Daiichi Nuclear Power Station

---

As of yesterday (April 10, 2013), the steel frame construction has been completed in the area below (indicated by a pink dotted line). The steel frame construction for the part which sticks out from the upper part of the 5th floor of the Reactor Building will be implemented.

Materials used: 30 columns and 34 beams (Total: 64)

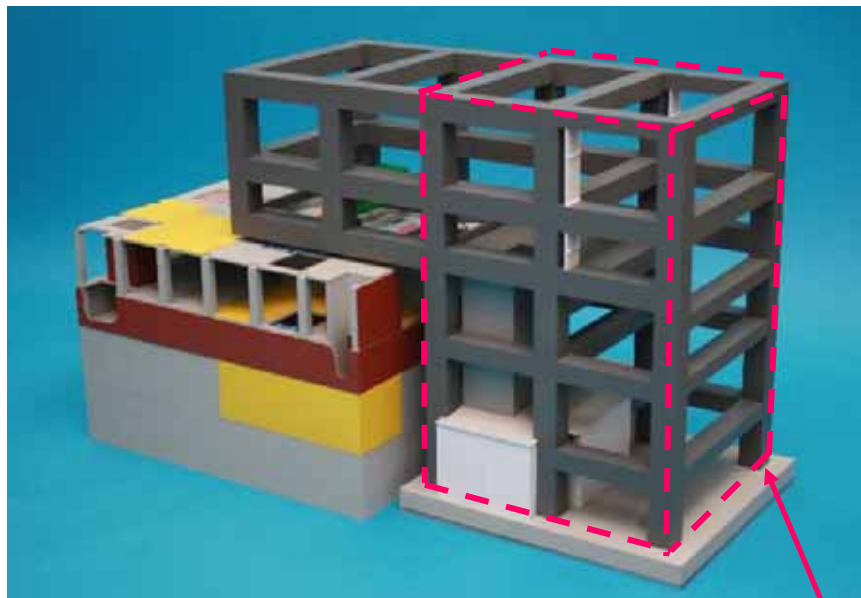

Simulated image of the cover to be installed for fuel removal



Progress status of the steel frame construction (as of April 10, 2013)

Photo taken on April 10, 2013 by TEPCO

Area in which the steel frame construction has been completed