

August 9th, 2011
Tokyo Electric Power Company

Installation of a cover for the reactor building of unit 1, Fukushima Daiichi Nuclear Power Station

- Tentative assembling of unitized materials at Onahama port in preparation for the work in the site. (June 13th to July 21st)
- Assembly of crawler cranes (2 large heavy machineries) in the site (Shallow Draft Quay) (June 12th to July 6th)
- Initiated main construction including covering and exhaust system from June 27th.
- Initiate iron frame construction from August 10th.(from the marked point)

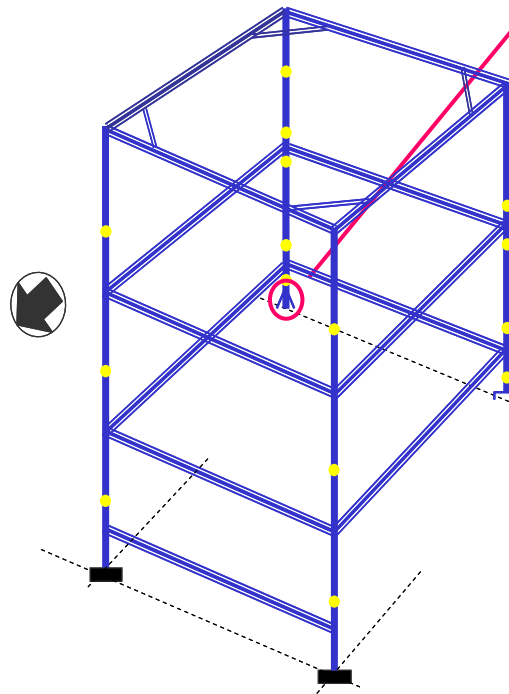
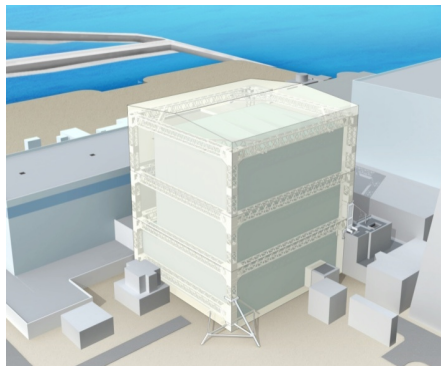

Image

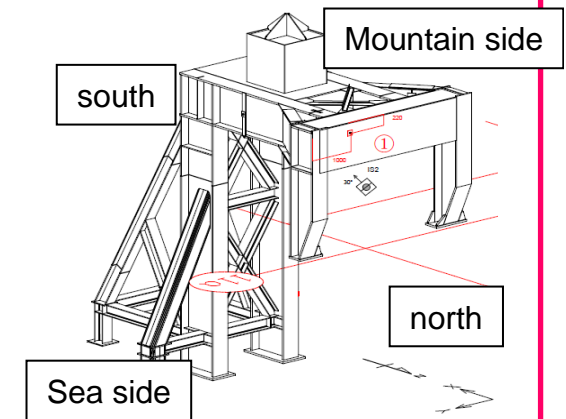

Unloading of iron framework
(Jul 26, 2011) source: TEPCO

Image of the cover (iron framework) for the reactor building