

Overview of the blocking operation of the units 1 – 4 openings

< Reference >
November 2, 2011
Tepco

【 Intent 】

- The openings leading to the basements will be blocked for the purpose of blocking of high airflow, in order to control the dust concentration increase caused by the drawdown of the basement accumulated water in the following buildings :
Units 1 - 4 Turbine Buildings, Radioactive Waste Disposal Building, Process Main Building, Miscellaneous Solid Waste Volume Reduction Treatment Building, On-site Bunker Building, Incineration Workshop Building
- Large openings leading to the basements will be blocked, such as stairs and equipment hatches.
- Partitioned areas, openings of which are large will be blocked as a whole (heater room etc.)

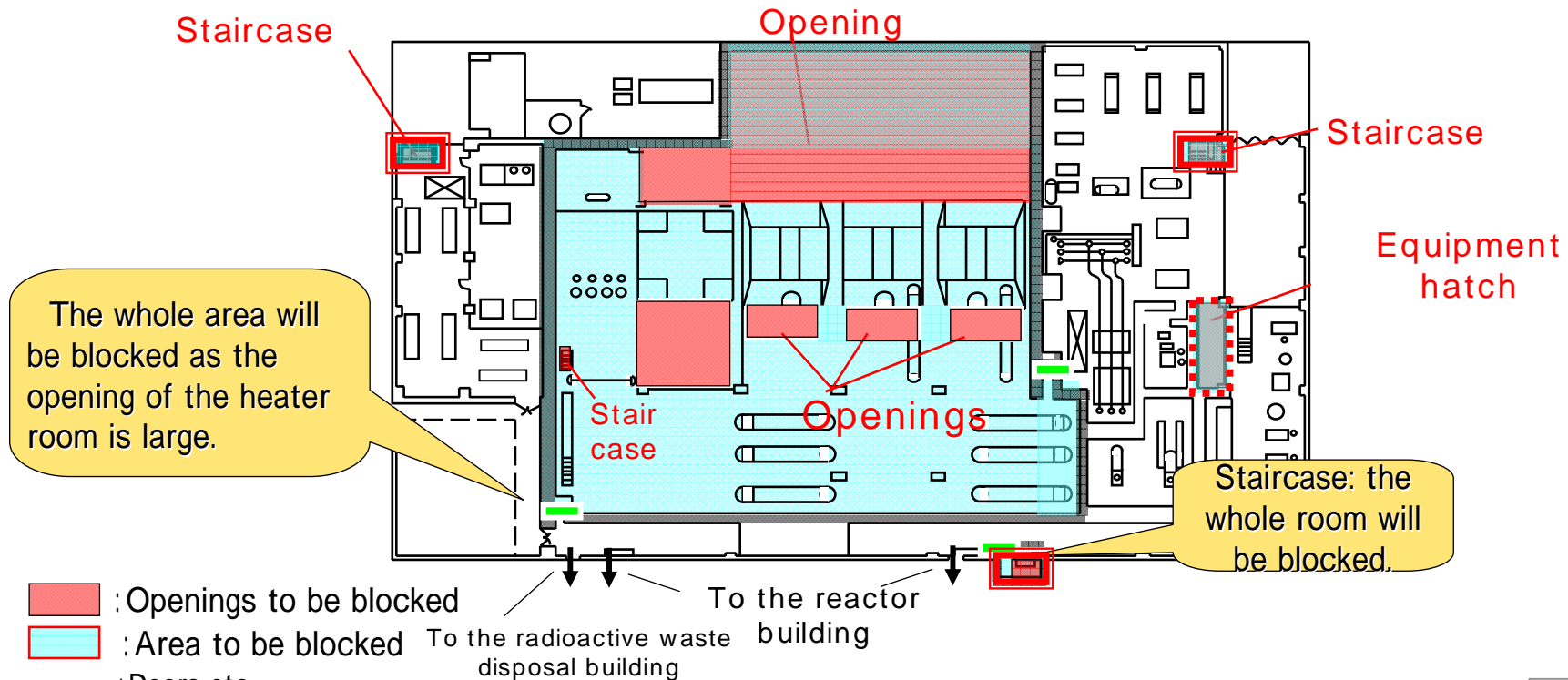

Example : ground floor of the unit 2 turbine building

Situation of Covering the Opening (Stair)

Stair : Scaffolding and covering incombustible sheets on the opening area. Then finishing by urethane foam.

Stair Room: Covering sheets or closing doors.

Stair at Unit 1 turbine building (1F)



Before block



After Block

Stair at On-site Bunker Building (2F)



Before block



After Block

Situation of Covering the Opening (Opening of Machine hatch)

Hatch : Covering the whole device by incombustible sheets (Also taking anti-drop countermeasure)

Hatch at On-site Bunker Building (2F)



Before block



After block

Situation of Covering the Opening (Covering Area)

Entrance of heater room : double curtains in consideration of traffic of people and equipment.

Unit 1 turbine building : Entrance of heater room (1F)



Before block



After block

Elevator Room : Curing by incombustible sheets (Also preventing from entering.)

Process Main Building : Elevator room (1F)



Before Block



After Block

Prevention from entering

Situation of Covering the Opening (Machine hatch : Balloon method)

Unit 2,3,4 turbine building southern side large machine hatch
: In case of large opening, Covering the Opening by balloon method
Unit 4 turbine building large machine hatch (photo from 2F)



Before construction



After construction

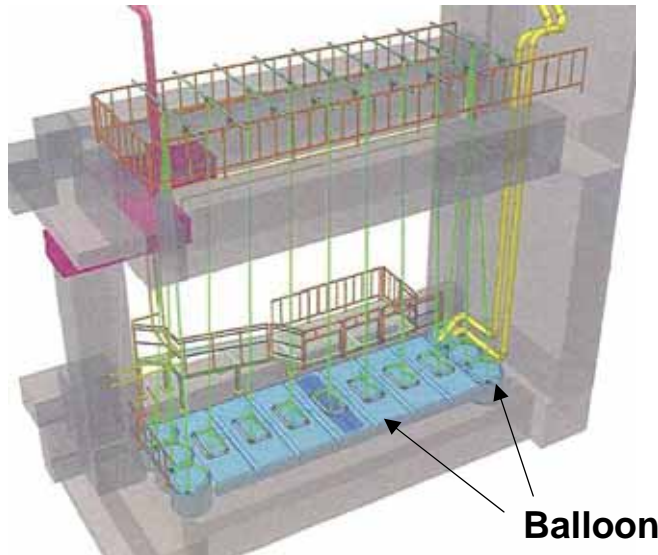

Image of Balloon method

Situation of Covering the Opening (Turbine maintenance hatch)

Unit 1-4 Turbine maintenance hatch : Covering the opening by incombustible sheet

Unit 2 turbine building (2F) : Turbine maintenance hatch



Before block



After block

Situation of Covering the Opening (Opening near Unit 4 combination middle valve)

Covering the whole device by incombustible sheet

Opening near Unit 4 turbine building (2F) combination middle valve



Before block



After block